

ALTERNATIVE 4 - ROADWAY CROSS SECTION:

- 1 - 3.6 m (12') TRAFFIC LANE EACH DIRECTION
- 1 - 3.6 m (12') DUAL CENTER TURN LANE
- 1 - 1.5 m (5') BIKE LANE EACH DIRECTION
- 1 - 5.3 m (18±) SIDEWALK/PLANTING AREA EACH DIRECTION
(SEE SHEET 18 FOR TYPICAL X-SECTION - ALTERNATIVE 4)



REVISION #	DATE	DESCRIPTION AND SHEET NO.	APPROVED BY:	DATE:

THE COUNTY OF PLACER OR ITS OFFICERS OR AGENTS SHALL NOT BE RESPONSIBLE FOR THE ACCURACY OR COMPLETENESS OF ELECTRONIC COPIES OF THIS PLAN SHEET.

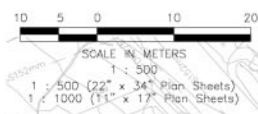

- 5.3 m (18±) SIDEWALK/PLANTING AREA
- CURB & GUTTER
- 1.5 m (5±) BIKE LANE
- 3.6 m (12±) TRAFFIC LANE
- 3.6 m (12±) DUAL CENTER TURN LANE

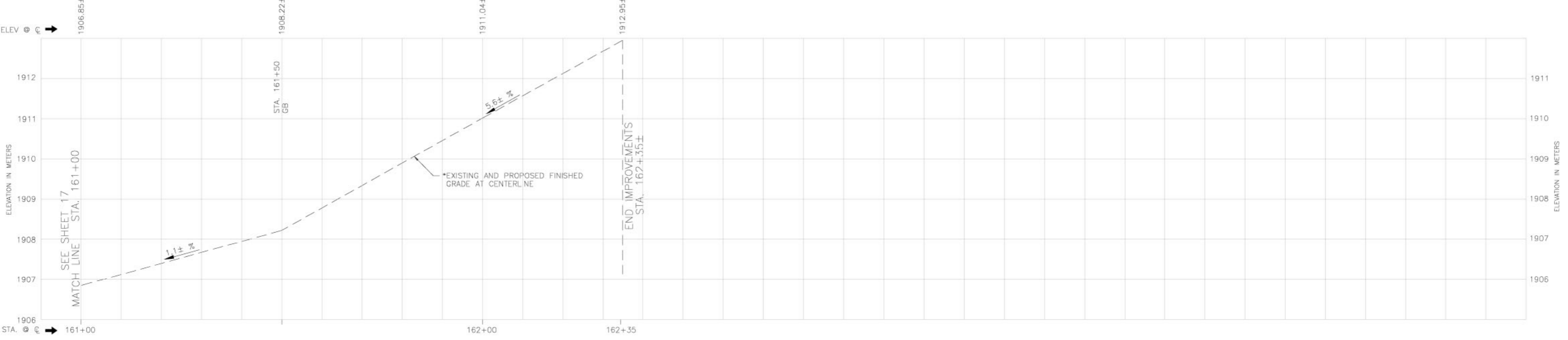

PLAN SCALE: 1:500
PROFILE SCALE:
HORIZ: 1:500
VERT: 1:50

CONTRACT NO. 73108
DATE: 12/01/06
DESIGNED: BRS
DRAWN: BRS
CHECKED: RTL
RECORD DRAWING

DEPARTMENT OF PUBLIC WORKS
COUNTY OF PLACER
KINGS BEACH COMMERCIAL CORE IMPROVEMENT PROJECT
FEASIBILITY STUDY - ALTERNATIVE 4 - PLAN, PROFILE & STRIPING LAYOUT

SHEET NO. 17 OF 18

Figure 2-1 Kings Beach Commercial Core Improvement Project Alternatives

Source: Dokken Engineering